

Trespa Perspectives Character

Texture - Materials - Encounter - Joints

DISCLAIMER

General

These terms apply to the use of this document and such use automatically means that the other party agrees to these terms. The information provided by Trespa International B.V. ("Trespa") in this document is solely indicative. Trespa is unable to warrant the accuracy and completeness of this information. Trespa may change the information included in this document at any time and without further notice. Trespa's customers and third parties must ascertain that they have the most recent document (for the most recent version, please consult: www.trespa.com). No rights can be derived from the information provided; the use of the information is at the other party's risk and responsibility.

Trespa does not warrant that the information in this document is suitable for the purpose for which it is consulted by the other party. This document does not contain any design, structural calculation, estimate or other warranty or representation that customers and third parties may rely on. This document does not guarantee any properties of Trespa products. Colours used in Trespa's communications (including but not limited to printed matter) and in samples of Trespa's products may differ from the colours of the Trespa products to be supplied. Samples are not intended for use in product tests

CONTACT US

Trespa International B.V.
P.O. Box 110, 6000 AC Weert
Wetering 20, 6002 SM Weert
The Netherlands
www.trespa.com

**Customer Service Desk
EMEA Export**
Tel.: +31 (0) 495 458 359 / 573
Fax: +31 (0) 495 458 383
infoexport@trespa.com

Trespa UK Ltd.
Grosvenor House
Hollinswood Road
Central Park, Telford
Shropshire, TF2 9TW
United Kingdom
Tel.: +44 (0) 1952 290707
Fax: +44 (0) 1952 290101
info@trespa.co.uk

and are not representative of characteristics of the Trespa products. Trespa's products and samples are produced within the specified colour tolerances and the colours (of production batches) may differ, even if the same colour is used. The viewing angle also influences the colour perception. Metallic panels feature a surface whose colour appears to change based on the direction from which it is viewed. The specified colour stability and colour specifications relate only to the decorative surface of the Trespa products, not to the core material and samples of the Trespa products. Trespa products are delivered ex-works with straight, sawn sides.

Customers and third parties must have a professional adviser inform them about (the suitability of) the Trespa products for all desired applications and about applicable laws and regulations. Trespa does not warrant the above.

The most recent version of the current delivery programme and the Material Properties Datasheet can be found at www.trespa.info. Only the information in the most recent and valid Material Properties Datasheet should be used to select and provide advice regarding Trespa products. Trespa reserves the right to change (the specifications for) its products without prior notice.

Trespa North America Ltd.
12267 Crosthwaite Circle
Poway, CA 92064
United States of America
Tel.: 1-800-487-3772
Fax: 1-858-679-9568
info.northamerica@trespa.com

Trespa China Co. Ltd.
Room 2604-05, HuaiHai Plaza
No. 1045 HuaiHai Road (central)
ShangHai 200031
P.R. China
Tel.: +86 (0) 21 6288 1299
Fax: +86 (0) 21 6288 1296
infochina@trespa.com

**Customer Service Desk
Asia/Pacific**
Tel.: +86 (0) 21 5465 8388
Fax: +86 (0) 21 5465 6989
infoapac@trespa.com

Liability

Trespa is not liable (neither contractual nor non-contractual) for any damage arising from or related to the use of this document, except if and to the extent that such damage is the result of wilful misconduct or gross negligence on the part of Trespa and/or its management. The limitation of liability applies to all parties affiliated with Trespa, including but not limited to its officers, directors, employees, affiliated enterprises, suppliers, distributors, agents, and representatives.

General conditions

All oral and written statements, offers, quotations, sales, supplies, deliveries and/or agreements and all related activities of Trespa are governed by the Trespa General Terms and Conditions of Sale (*Algemene verkoopvoorwaarden Trespa International B.V.*) filed with the Chamber of Commerce and Industry for Noord- en Midden-Limburg in Venlo (NL) on 11 April 2007 under number 24270677, which can be found on and downloaded from the Trespa website, www.trespa.com.

All oral and written statements, offers, quotations, sales, supplies, deliveries and/or agreements and all related work of Trespa North America, Ltd. are governed by the Trespa General Terms and Conditions of Sale, which can be found on and downloaded from the

www.trespa.com website, www.trespa.com/na. A copy of these general conditions of sale will be provided free of charge on request.

All general terms and conditions other than the conditions mentioned above are dismissed and do not apply, regardless of whether such terms and conditions are referred to on requests for offers, offer confirmations, stationery and/or other documents of the other party, even if Trespa does not expressly object to such terms and conditions.

Intellectual property

All intellectual property rights and other rights regarding the content of this document (including logos, text and photographs) are owned by Trespa and/or its licensors. Any use of the content of this document, including distribution, reproduction, disclosure, storage in an automated data file or the dispatch of such a file without Trespa's prior written consent is explicitly prohibited.

® Trespa, Meteon, Athlon, TopLab, TopLab^{PLUS}, TopLab^{ECO-FIBRE}, Virtuon, Volkern, Trespa Essentials and Mystic Metallics are registered trademarks of Trespa.

Questions

Should you have any questions or comments, please do not hesitate to contact Trespa.

www.trespa.com

VISIT US

**Trespa Design Centre
New York**
62 Greene Street (Ground Floor)
New York, NY 10012
United States of America
Tel.: 1-212-334-6888
Fax: 1-866-298-3499
info.ny@trespa.com
www.trespa-ny.com

**Trespa Design Centre
Barcelona**
Calle Ribera 5,
08003 Barcelona
Spain
info.barcelona@trespa.com

When you
read between
the lines,
think Trespa

code U2612 date 04-2011 copies 0

Please visit www.trespa.com
for the most up to date version
of this document.

TRESPA®

A façade's character
is more than just
shapes and lines - it's
in the very materials
themselves.

Variations down to the joints

Use joints to dominate a façade.

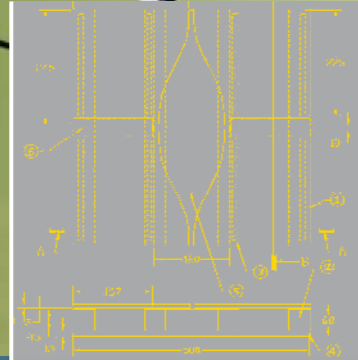
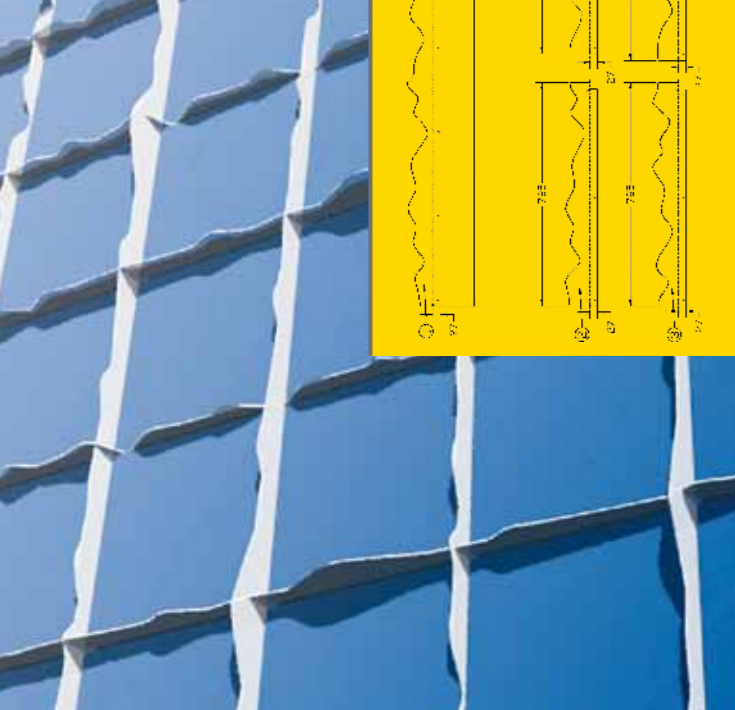
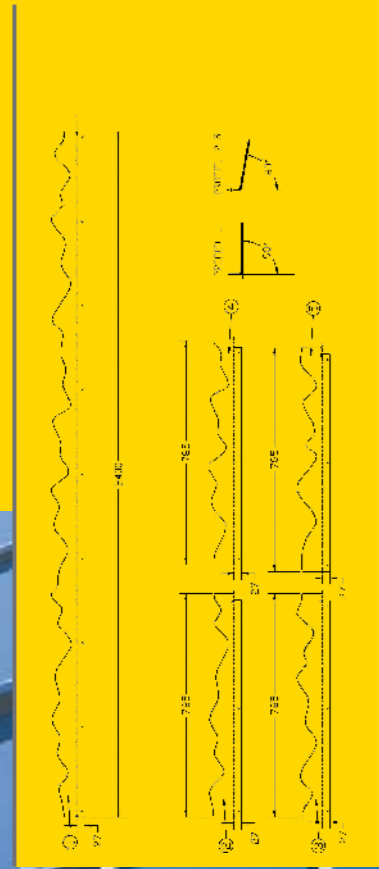

Incorporate nature as a continuous display of inspiring beauty.

Nature must take its' course

Combined impact

Even the roughest character has an intrinsic beauty.



Enlightened ideas



Light effects in the joints to give your façade distinctive characteristics that vary with the time of day and night.

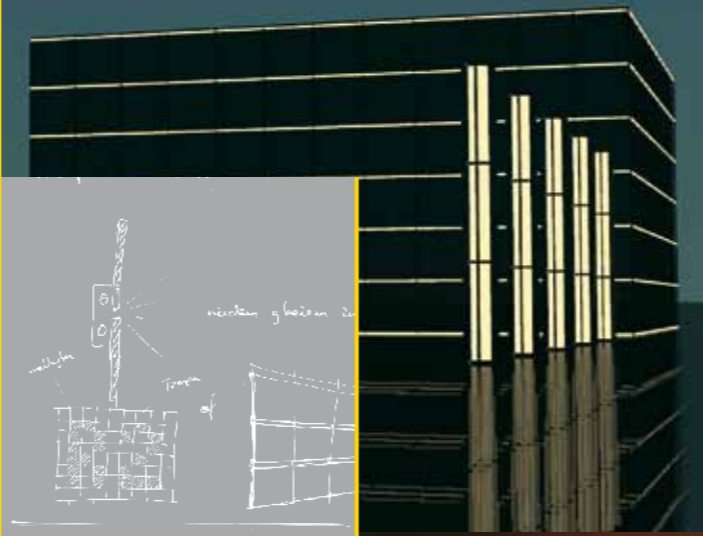

Character

Façades with an emotional value

Don't limit your design to the possible. Go beyond...with Trespa Meteon. All building materials display a unique character, glossy, soft, rough, natural. Trespa Meteon external panels let you fully express this emotive power. Combine our panels with wood, metal, glass, concrete and brick, add special joint elements and structures, and you can design façades that are bold... soaring... whimsical... inspiring... daring.

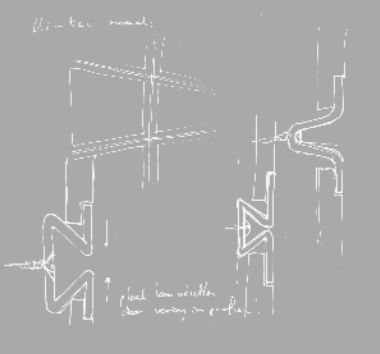
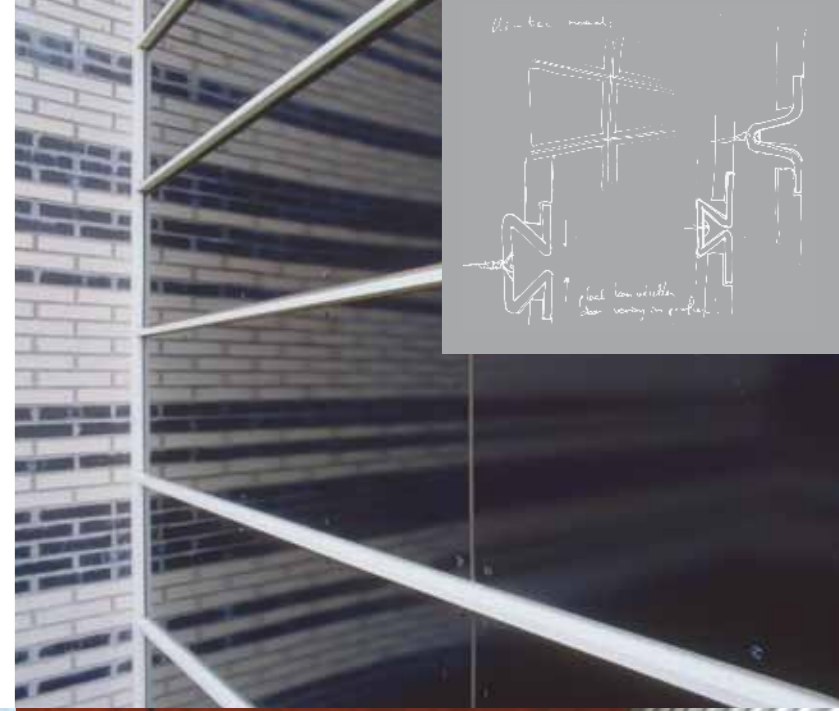

Inspiration comes to life
With a broad range of colours, finishes and tactile effects, Trespa Meteon brings compelling aesthetic and nearly limitless design possibilities to next-generation architectural claddings. Depending on the architectural concept, Trespa Meteon can contribute effectively to energy efficient, healthy building designs with a positive impact on long-term performance and value. Come and be inspired: <http://perspectives.trespa.com>

The designs shown in this brochure are for inspiration only and have not been submitted to specific tests. Actual designs may vary, depending on specific location, regulations and circumstances. Design and fixing systems may influence possible end results. Trespa Meteon is CE marked and fully complies with the EU standard. Always check if the desired design is in accordance with any national and/or local building regulations and specifications.